

STEP 1 - MORTISE CUT OUT

1. Decide upon desired installation height for mortise lock
2. Mark fixing screw holes using the attached template aligning it in the centre of the door
3. Mark 9 x 19mm diameter holes as per attached template
4. Drill 2 x 2mm diameter fixing holes top & bottom as per attached template
5. Drill 9 x 19mm diameter holes as per attached template
6. Smooth out edges of 19mm holes with a chisel so that the mortise lock can slide into the mortised cavity with out requiring any level of force
7. Insert the lock and trace around the faceplate - this will need to be chiseled out to accommodate for the faceplate. It should be chiseled to a depth of approx 2-3mm
8. Ensure mortise can be placed inside the mortised cavity and face plate cut out is a snug fit

STEP 2 - PRODUCT HANDING

1. Loosen allen key screw with allen key provided & move it in the up position
2. Push latch inside lock housing and turn around 180 degrees so that flat side is facing to the inside
3. Release latch back out of the housing
4. Re-tighten allen key screw in the bottom position
5. Test by pushing latch in and out of the housing with your fingers

STEP 3 - LOCK & PLATE INSTALLATION

1. Place provided template on door with the fold line on the egde of the door
2. Mark the spot for the 54mm diameter hole - **THIS HOLE TO BE DRILLED ALL THE WAY THROUGH THE DOOR**
3. Mark the spot for the 25mm diameter hole -
THIS HOLE IS TO BE DRILLED ON THE INSIDE OF THE DOOR ONLY - STOP DRILLING WHEN YOU REACH THE MORTISE CUT OUT
4. Insert the mortise lock into the mortise cut out and fix with the 2 screws provided into the the 2 x 2mm holes that were previously drilled
5. Insert the eurocylinder and secure with long screw provided
6. Insert the small spindle into the square spindle hole that is visible through the 25mm face hole
7. Place the inside plate with the turn on the inside of the door - **PLEASE NOTE - IF THE LATCH IS IN THE LOCKED POSITION, INSTALL WITH THE TURN FACING HORIZONTALLY. IF THE LATCH IS INSIDE THE MORTISE LOCK CASING, INSTALL WITH THE TURN IN THE VERTICAL POSITION**
8. Place the outside plate around the eurocylinder on the outside of the door and secure with the two screws provided
9. Place the escutcheon plate over the screws and snap into place

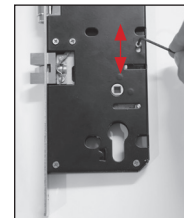

TOP -
UNLOCK POSITION

BOTTOM -
LOCK POSITION



PUSH LATCH IN AND
SWIVEL TO DESIRED
POSITION

RETIGHTEN ALLEN
KEY SCREW TO THE
BOTTOM POSITION
WHEN FINISHED



INSERT AND FIX
LATCH TO DOOR

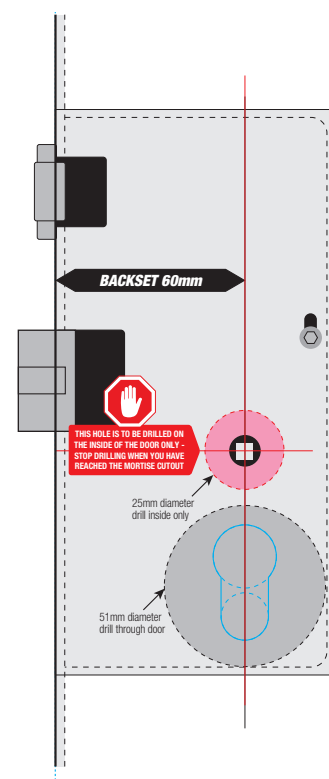

Fold here against door edge → **THIS SIDE UP**

Align with centre line on door edge

THIS SIDE UP ← Fold here against door edge

SIDE 1

SIDE 2

BACKSET 60mm

BACKSET 60mm

THIS HOLE IS TO BE DRILLED ON THE INSIDE OF THE DOOR ONLY - STOP DRILLING WHEN YOU HAVE REACHED THE MORTISE CUTOUT

THIS HOLE IS TO BE DRILLED ON THE INSIDE OF THE DOOR ONLY - STOP DRILLING WHEN YOU HAVE REACHED THE MORTISE CUTOUT

Centre for 51mm drill hole

51mm drill through door

Centre for 51mm drill hole

51mm drill through door

This solid line represents the dimensions required for the Mortise Cavity of a 60mm Backset lock:
We recommend a cavity depth of 88mm x 179mm high x 19mm wide.

This solid line represents the dimensions required for the Mortise Cavity of a 60mm Backset lock:
We recommend a cavity depth of 88mm x 179mm high x 19mm wide.



BEFORE DRILLING CHECK THE MARKINGS ON THE DOOR FOR ACCURACY



BEFORE DRILLING CHECK THE MARKINGS ON THE DOOR FOR ACCURACY



BEFORE DRILLING CHECK THE MARKINGS ON THE DOOR FOR ACCURACY

Fold here against door edge →

Align with centre line on door edge

← Fold here against door edge

208mm

179mm

43mm

28mm

22mm

2mm Fixing Screw Hole

9 x 19mm Diameter holes required.
Use centre markings, Drill to 90mm in Depth.

2mm Fixing Screw Hole