

PARTS OF GATE/DOOR LOCK:

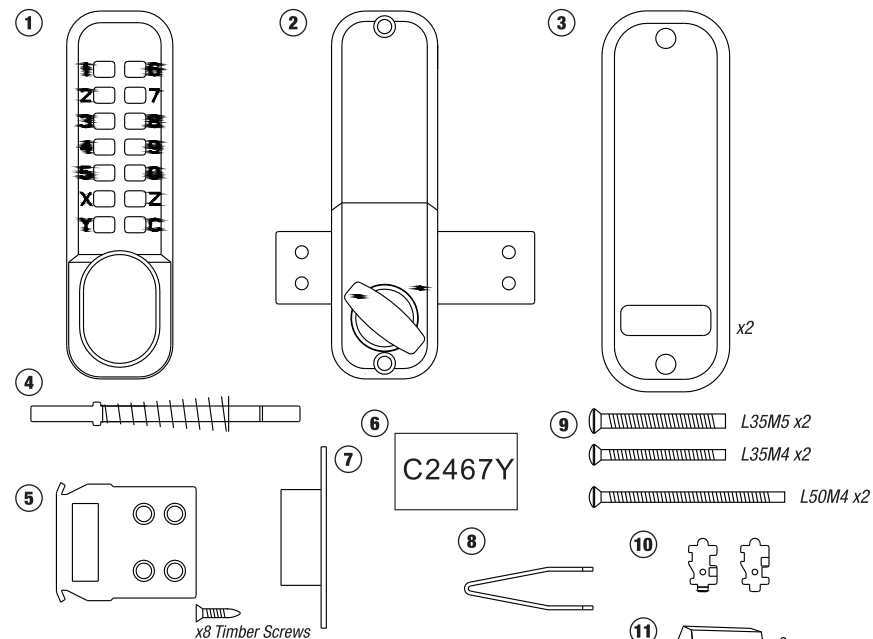

- 1-Lock Password Box
- 2-Interior Panel
- 3-Rubber Cushion x2
- 4-Lock Shaft (With spring)
- 5-Surface Mounted Strike Box
- 6-Password Card
- 7-Mortised Strike Box
- 8-Password Setting Forceps
- 9-Fixing Bolts (Length is adjustable)
- 10-Backup Connection Pin
- 11-Hexagonal Post

WORK DIRECTION OF DOOR:

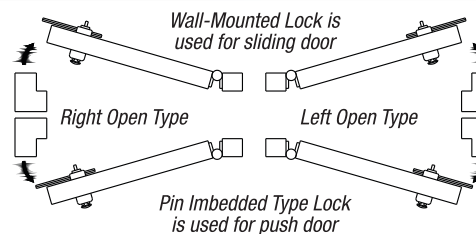

Gate/door is open from right hand side, viewing from the inside part of gate or door, the hinge is at the right side.

The installation direction of parts can be changed if necessary,

SHOWN BELOW:

Gate or door lock password box:

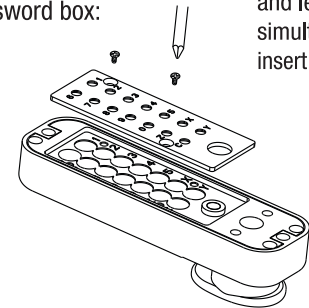

Remove the rear panel, then remove the column pin with small forceps, remove the right pin for left-open gate/door, and left pin for right-open door (re-install the pin if necessary, simultaneously turn the lock handle to make the pin completely insert into the hole). Install the panel and tighten the screws.

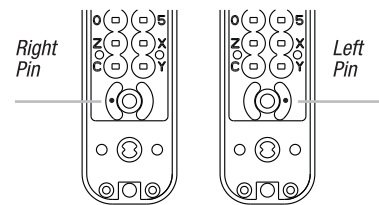

INTERIOR FIXING DEVICE:

Turn the handle and make the lock tongue at the position shown below according to the work direction of the gate/door, then tighten the screws of the panel.

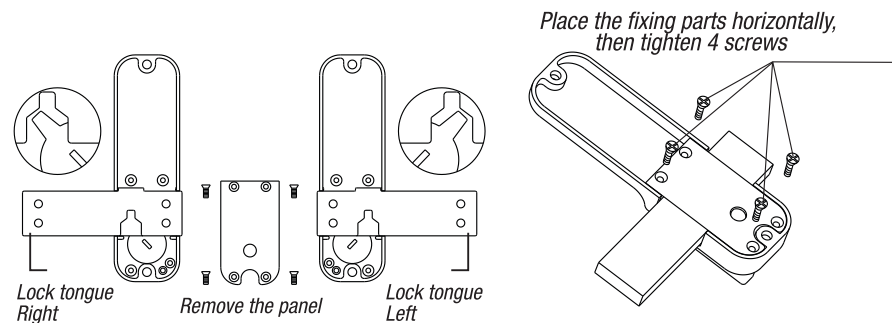

PRECAUTIONS:

Before installation, check and assure the password box works normally, the handle can be easily turned and reset after inputting the password. Check from the inside part of the gate/door, assure it can easily open and close the gate/door by turning the handle. It can only unlock through inputting the password from the outside of the gate/door. If one or two pins are taken out from the password box, when checking after closing the gate/door, it doesn't need to input the password (please refer to above).

INSTALLATION:

This lockset is suitable for a 19-20mm picket gate, and a 33-60mm door, gate or mounting area thickness. Cut the length of the lock shaft to suit the thickness of the door, gate or mounting area.

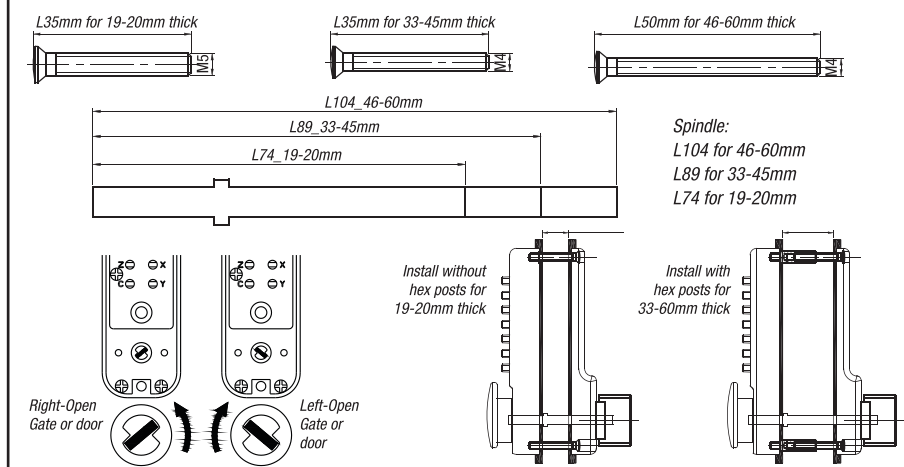

Do not forget to install the rubber cushion when installing the password box and interior part. Tighten the screws.

Select suitable lock beam according to the gate/door frame.

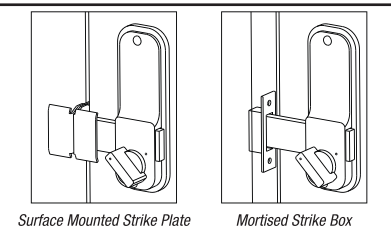

IMPORTANT CAUTIONS:

Do not close the gate/door before confirming the password lock works normally.

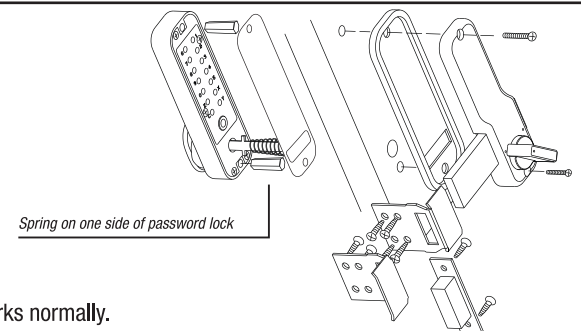

Gate/door side shaft lock: 60mm

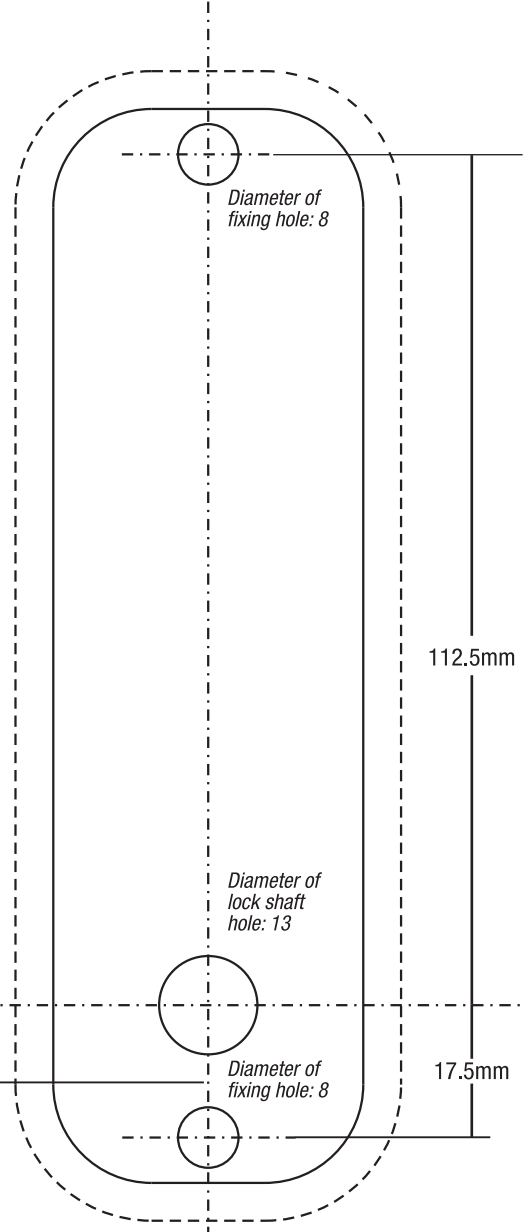

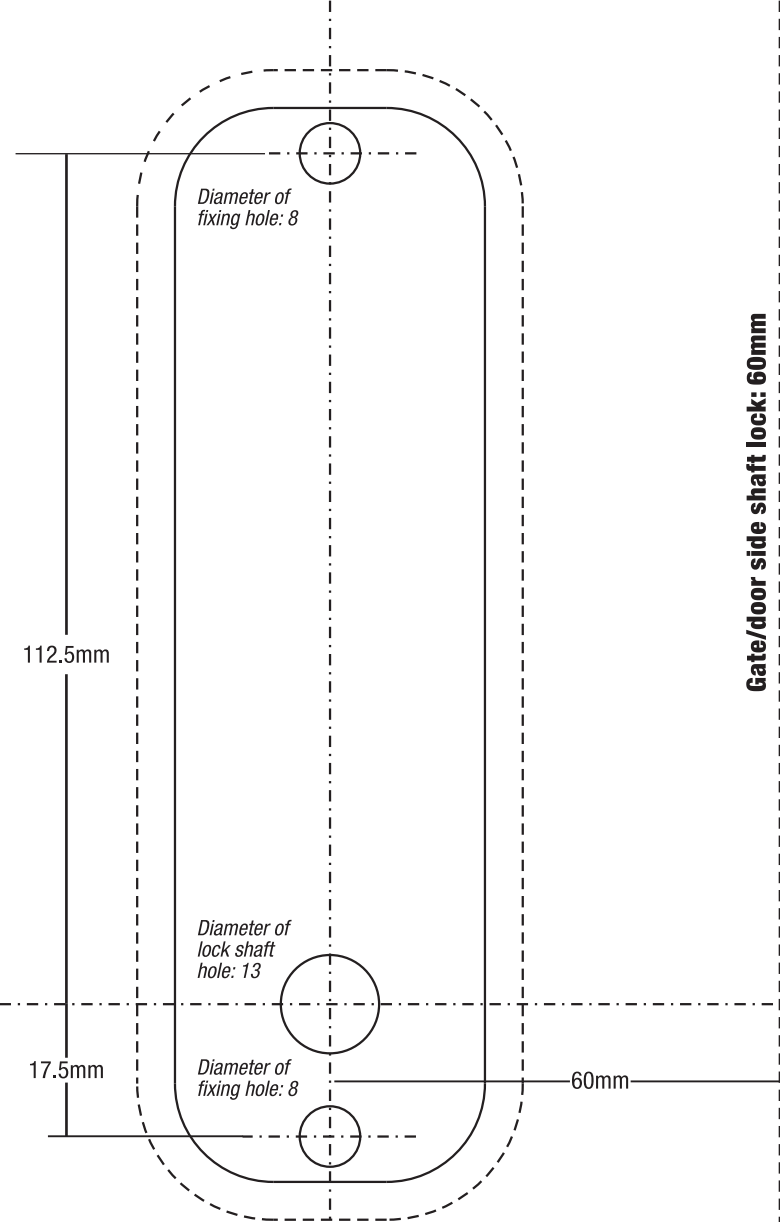

MODIFY PASSWORD:

1 Remove the gate/door lock box
Loosen the two fixing screws, and then remove the gate/door lock box

2 Press button C

3 Remove the rear panel
Turn over the gate/door lock box, loosen the screws and then remove the rear panel.

Carefully remove the panel, preventing the spring falling down, make the side without spring downwards and then put it onto desk.

4 Expose the top of the connection pin, one is light color (corresponding connection pin of button C), and others are red or blue.

5 Cancel all password settings
Remove all red and blue connection pins with small forceps.

Caution: Do not remove the light colored connection pin of button C.

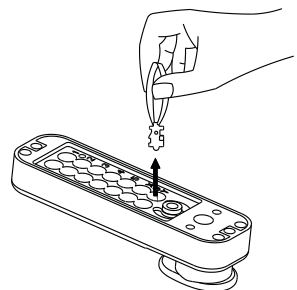
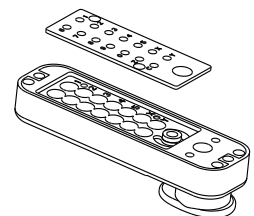
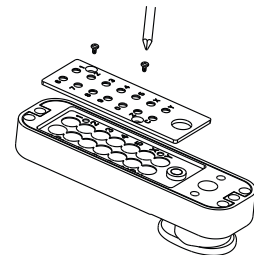
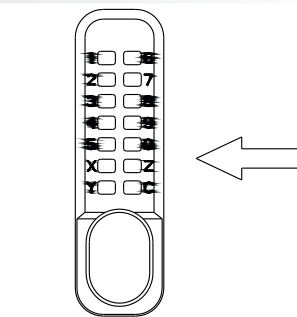

MODIFY PASSWORD:

Important Cautions:
Please hold button C when removing or assembling connection pin.
The password lock may possibly be seriously damaged if above instruction is neglected.

6 Set new password
After selecting the numbers or letters for the password, connect the red connection pin with the corresponding holes of the password. Pay attention to the direction of connection pin.

The rectangle and hollow part shall aim at the external part of the gate/door lock, otherwise, the connection pin can't be completely inserted into the hole.

Insert all blue connection pins into the rest holes.

TIP:
Do not release button C.

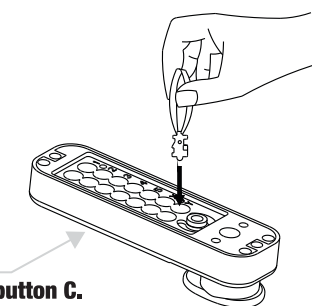

MODIFY PASSWORD:

7 Assemble the gate/door lock and check if the gate or door lock works normally

Check all springs, then install the rear panel and tighten the screws.

8 Hold button C before install the lock in the gate/door, and then check if the password works normally.

Confirm the work direction of the gate/door (Please refer to "Installation Instructions")

And check if the gate/door handle works normally.

9 Install the lock in the gate/door
Install the lock in the gate/door with two bolts, assure the lock shaft keep at correct direction (Please refer to "Installation Instructions")

Before close the gate/door,
Hold button C and check if the password works normally, then check if the gate/door handle and lock works normally.

